

FOR LEASE

# COMMONS AT ROYAL PALM

501-543 N STATE ROAD 7, ROYAL PALM BEACH, FL



POTENTIAL OUTPARCEL  
OPPORTUNITY!

PRIME POWER CENTER IN DENSE RETAIL CORRIDOR

EXCLUSIVE RETAIL LEASING

**KATZ & ASSOCIATES**

RETAIL REAL ESTATE ADVISORS

ALLAN CARLISLE  
DIRECTOR  
allancarlisle@katzretail.com  
(561) 385-4791

JON CASHION  
PRINCIPAL  
joncashion@katzretail.com  
(561) 302-7071

## PROPERTY OVERVIEW

### HIGHLIGHTS

- ±30,000 SF and ±1,300 SF available
- Potential outparcel opportunity!
- Premier power center in Royal Palm Beach
- Located on 441 just north of Southern Boulevard
- Regional trade area with over 50,000 VPD on State Road 7/US 441
- Very dense and upper income demos
- Join: **HOBBY LOBBY** **PartyCity** **SalonCentric**



### DEMOGRAPHICS

	1 Mile	3 Miles	5 Miles
POPULATION	8,840	72,155	187,961
HOUSEHOLDS	2,765	26,403	68,096
DAYTIME EMPLOYEES	7,070	59,055	154,024
AVERAGE HH INCOME	\$122,963	\$115,108	\$110,438
	5 Minutes	10 Minutes	15 Minutes
POPULATION	16,951	93,829	261,293
HOUSEHOLDS	5,662	33,962	97,528
DAYTIME EMPLOYEES	13,642	76,778	214,220
AVERAGE HH INCOME	\$127,267	\$117,896	\$102,370



## COMMONS AT ROYAL PALM | EXECUTIVE SUMMARY



N STATE ROAD 7 - 52,500 AADT

### TENANT ROSTER

1	Hobby Lobby	49,160 SF	6	SalonCentric	3,250 SF	13	True Nails	1,702 SF	18	Batteries & Bulbs
2	Available	30,000 SF	7-8	Royal Palm Brewing Co.	3,649 SF	14	Treasure Property Group	2,275 SF	19	Sally Beauty Supply
3	Party City	23,676 SF	9	Available	1,300 SF	15	Velocity Credit Union	2,120 SF		
4	Petsmart	18,875 SF	10	Yoga	1,289 SF	16	Starbucks	1,535 SF		
5	Dollar Tree	12,069 SF	11-12	Davita	7,104 SF	17	Mattress One			

# COMMONS AT ROYAL PALM | SITE PLAN



COMMONS AT ROYAL PALM | PROPERTY PHOTOS

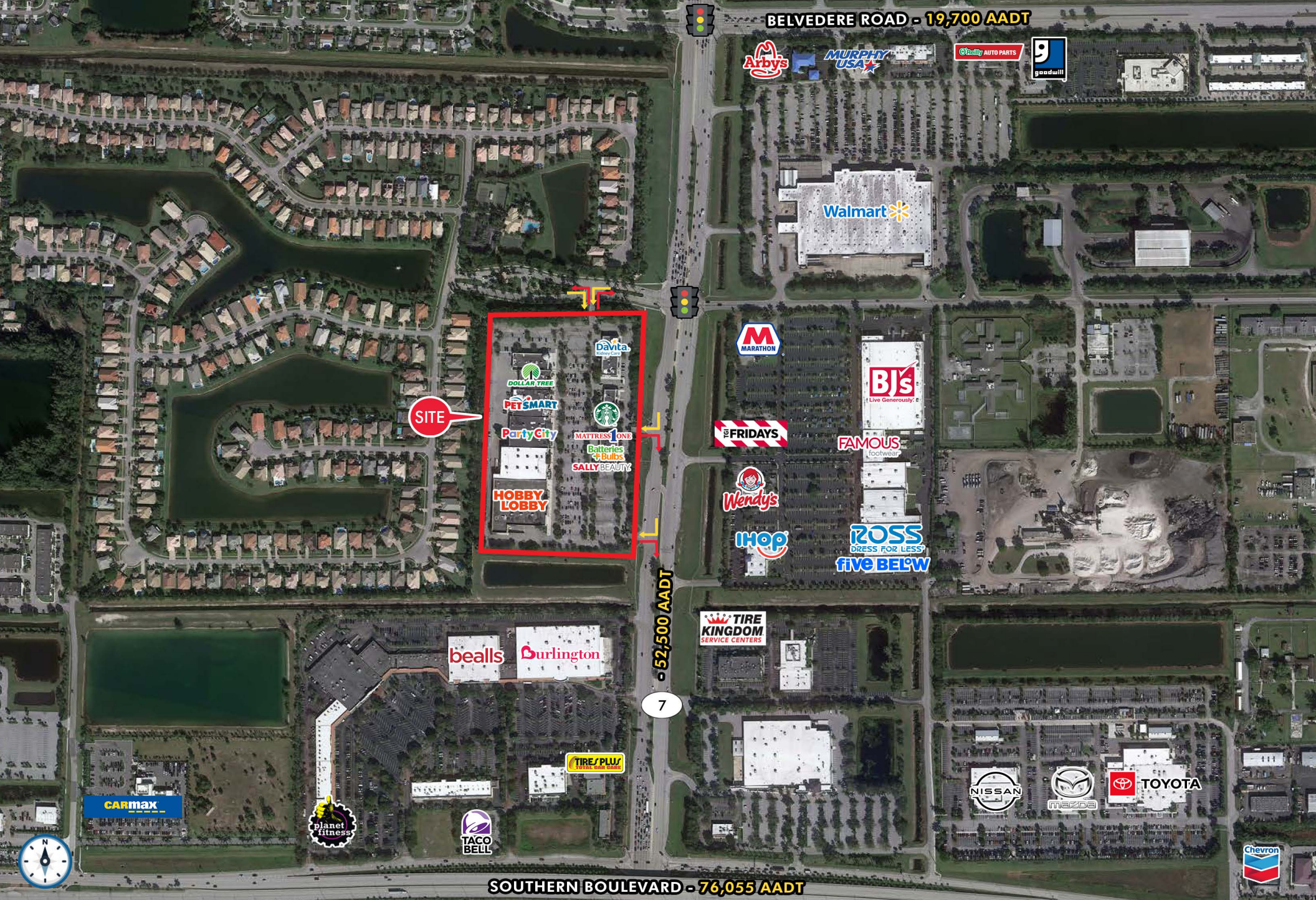

# COMMONS AT ROYAL PALM | CLOSE INTERSECTION AERIAL



# COMMONS AT ROYAL PALM | TRADE AERIAL



COMMONS AT ROYAL PALM | EXTENDED AERIAL

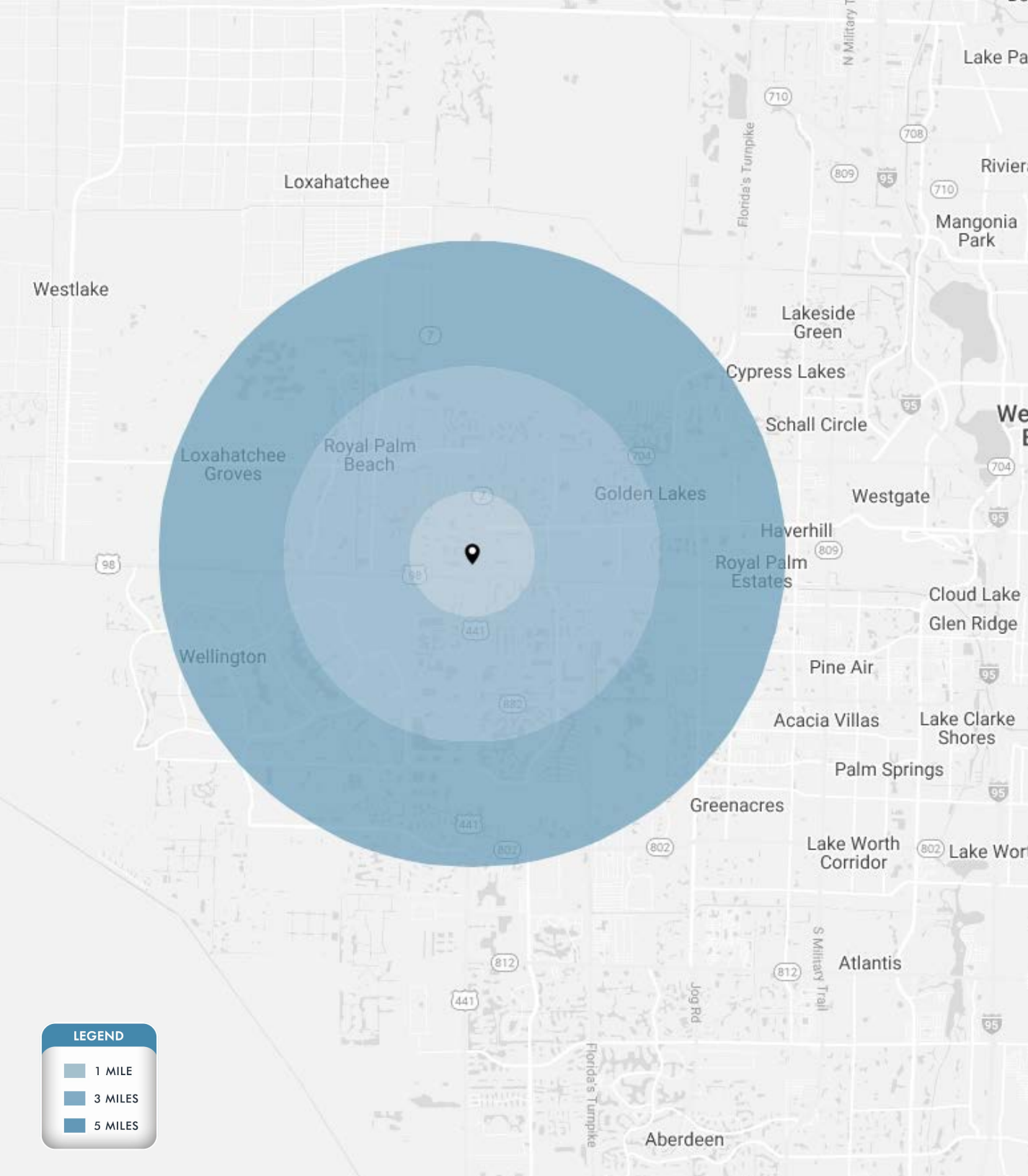

**LEGEND**

- 1 MILE
- 3 MILES
- 5 MILES

## CONTACT AGENTS

**ALLAN CARLISLE**  
 DIRECTOR  
[allancarlisle@katzretail.com](mailto:allancarlisle@katzretail.com)  
 (561) 385-4791

**JON CASHION**  
 PRINCIPAL  
[joncashion@katzretail.com](mailto:joncashion@katzretail.com)  
 (561) 302-7071



# KATZ & ASSOCIATES

RETAIL REAL ESTATE ADVISORS

[katzretail.com](http://katzretail.com)

The information herein was obtained from third parties and has not been independently verified by Katz & Associates. Any and all interested parties should have their choice of experts inspect the property and verify all information. Katz & Associates makes no warranties or guarantees as to the information given to any prospective buyer or tenant. REV: 06.04.24